

FEITIAN FIDO 2.0 scenarios instructions

Contents

- 1. Introduction 2
- 2.1. Dropbox 2
- 2.2 Microsoft account login 6

1. Introduction

This document describes for end-users how to set up FIDO 2 security key for per accounts.

2.1. Dropbox

Sign in your Dropbox and go to **Settings** tab.

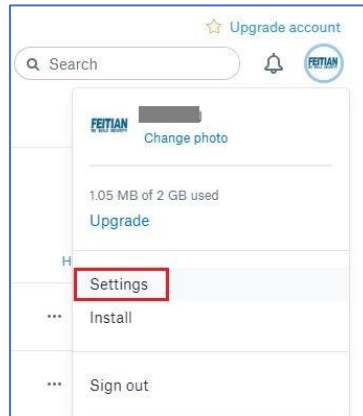

Under **security** tab, click highlighted **Off** to enable Two-step verification.

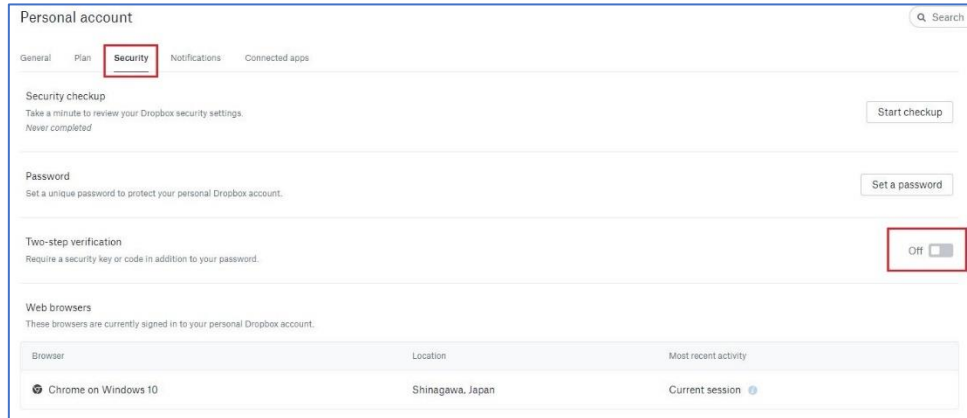

Follow the instructions.

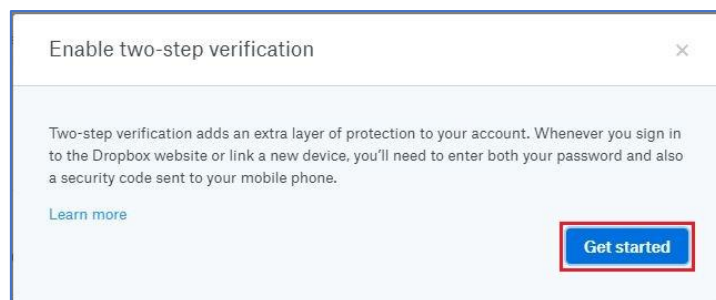

Enable two-step verification

For security, please enter your password for [redacted]

Enter your password and click Next

Enable two-step verification

How would you like to receive your security codes?

Use text messages
Security codes will be sent to your mobile phone

Use a mobile app
Security codes will be generated by an authenticator app

Enable two-step verification

Enter the security code generated by your mobile authenticator app to make sure it's configured correctly.

Input a backup phone number. **Note**, this is optional.

Enable two-step verification

Backup phone number (optional)
If you lose access to your primary security code source, we can send them to your backup mobile number instead.

China +86

While this step is optional, we encourage you to set up a backup phone number in case you lose your mobile phone or are otherwise unable to receive your security code.

Carefully save the one-time backup codes and click **Next**.

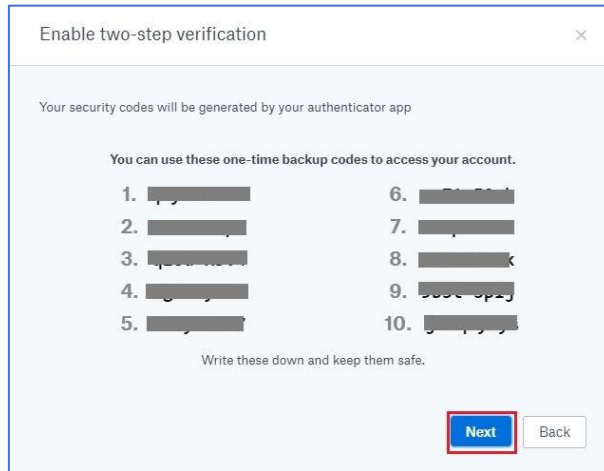

Read the lines and click **Next** and you have successfully enabled the two-step verification.

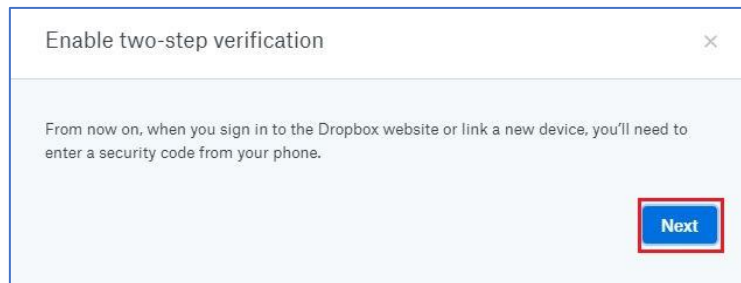

Register your FEITIAN ePassFIDO.

Click **Add** next to **Security keys** under **Two-step verification** tab.

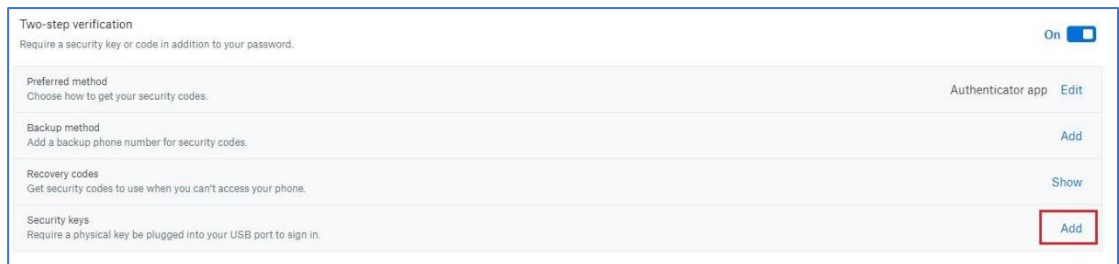

Follow instructions indicated as highlighted part.

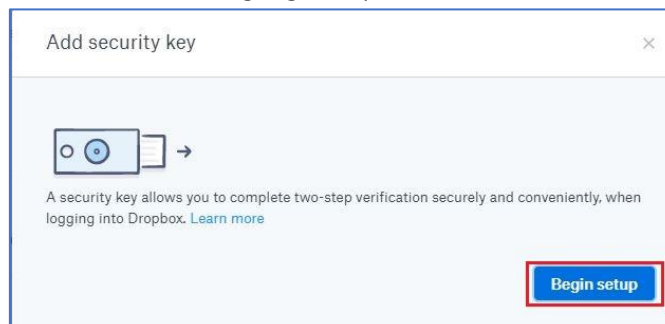

Enter your password and click **Next**.



Insert your FEITIAN ePass FIDO and press it.

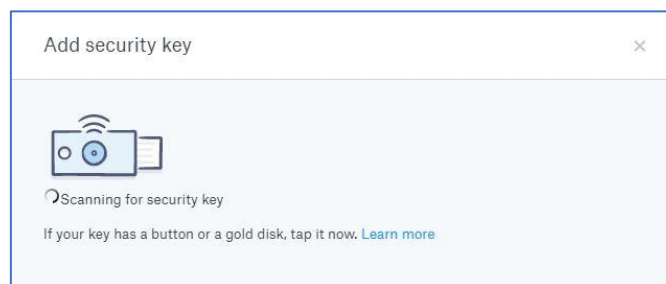
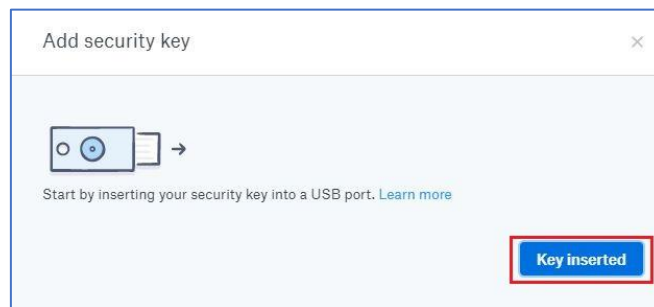

Click **Allow** on the pop-up window.

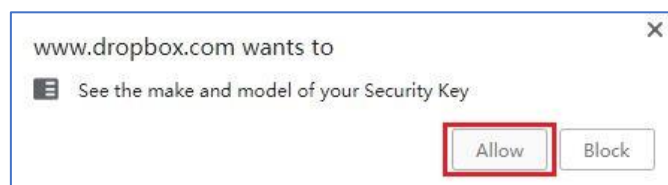

Finally, you have added a security key to your account.

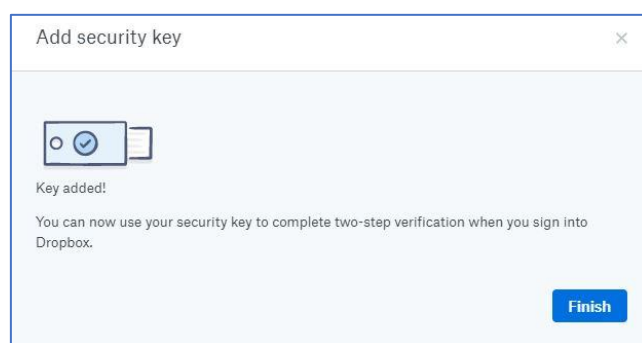

Next time after you input your account and password, it requires you to insert the added security key.



Enter Dropbox 2-step verification code



Insert your security key to use it 

After inserting, tap your key if it has a button or gold disk.

[Use mobile authenticator instead](#)

2.2 Microsoft account login

Requirement: Windows 10 Version 1809 or later and the Microsoft Edge browser

Go to the Microsoft account page and sign in as you normally would.

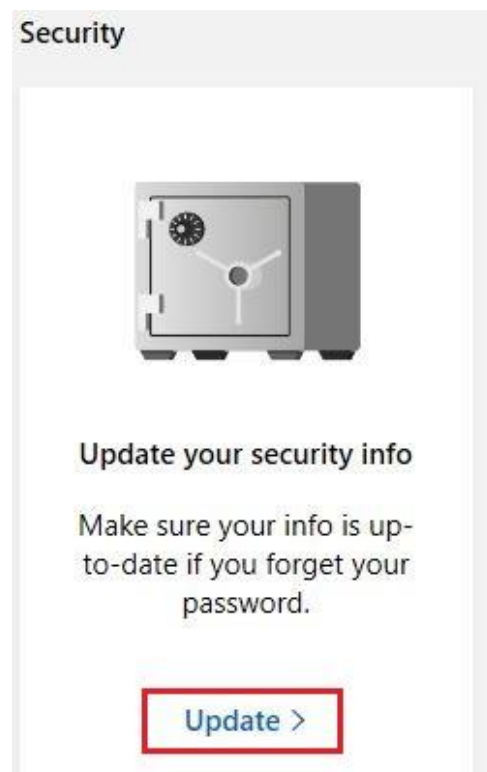

Select **Security > Update**



Choose **More security options**.

Security basics

Make your account more secure.

<p>Change your password</p>  <p>Make your password stronger, or change it if you think someone else knows it.</p> <p>CHANGE PASSWORD ></p>	<p>Update your security info</p>  <p>Make sure your info is up to date. This is how you'll prove you're you if you ever forget your password.</p> <p>UPDATE INFO ></p>	<p>Review recent activity</p>  <p>See when and where you've signed in, and let us know if something looks unusual.</p> <p>REVIEW ACTIVITY ></p>
--	--	---

Done with the basics? Explore [more security options](#) to help keep your account secure.

Under Windows Hello and security keys, select **Set up a security key**.

Additional security options

Manage how you sign-in to Microsoft

Make sure the list of phone numbers or email you use to sign in to your account is up to date. Turn off sign-in preferences for any phone number or email you don't use often.

[Manage sign-in options](#)

Two-step verification

Two-step verification is an advanced security feature that makes it harder for someone to break in to your account with just a stolen password. [Learn more about whether this is right for you.](#)

[Set up two-step verification](#)

Identity verification apps

A smartphone app is the fastest way to verify your identity. [Learn more.](#)

Before you can set up an identity verification app, you need to add another phone number or alternate email address, or verify an existing one.

[Set up identity verification app](#)

Windows Hello and security keys

Now you can sign in without a password using Windows Hello or security keys. A security key is a physical device (like a USB security key) that you can use to sign in to your account instead of a password. [Learn more about signing in with Windows Hello or a security key.](#)

[Set up a security key](#)

[Set up Windows Hello](#)

[Manage your sign-in methods](#)

Identify what type of key you have (USB or NFC) and select Next.

Set up your security key

Have your key ready



USB device



NFC device

To use a USB security key, when prompted, plug it into your USB port. Then touch the gold circle or button if your key has one when prompted for follow up action.

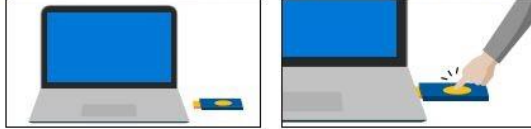

For detailed instructions on how your keys should be connected, please visit your key manufacturer's website.

Cancel

Next

You will be redirected to the setup experience where you will insert or tap your key.

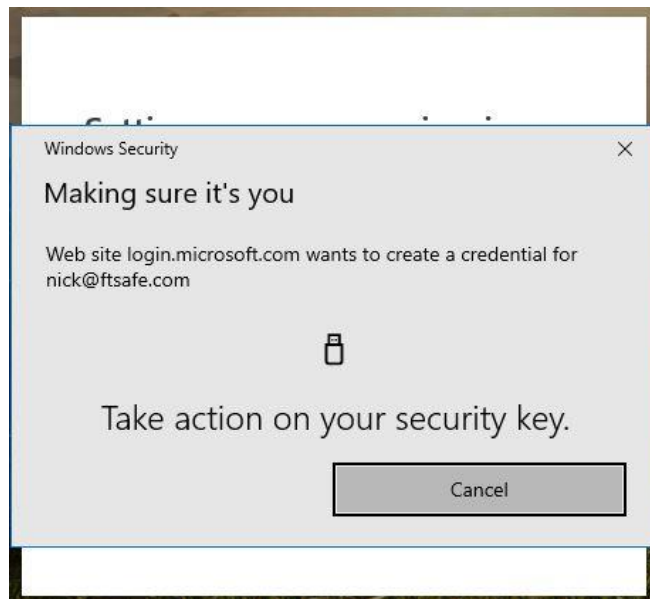

Create a PIN (or enter an existing PIN if you have already created one).

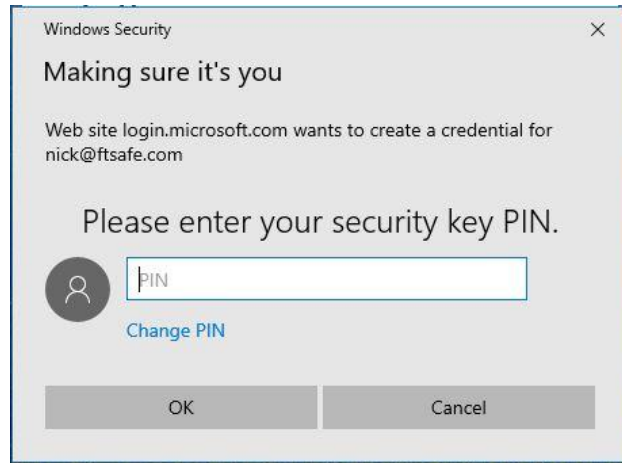

Take the follow-up action by touching either the button or gold disk if your key has one (or read the instruction manual to figure out what else it might be).

Name your security key so that you can distinguish it from other keys.

Set up your security key

Name your new security key

Hint: Name it so you'll know later which key this one is.

Next

Sign out and open Microsoft Edge, select Use Windows Hello or security key instead, and sign in by inserting or tapping your key.